



Central Bucks School District
LUNCH & LEARN PILOT

2019-2020









CB South High School

1100 Folly Road
Warrington, PA 18976

Jason Bucher, Principal
267.893.3033
jbucher@cbsd.org

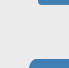
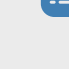
TABLE OF CONTENTS

	Rationale.....	2
	Purpose.....	4
	Vision & Mission.....	5
	Bell Schedule.....	6
	Teacher Collaboration Time.....	7
	Supervision.....	8
	Safety.....	9
	Student Expectations.....	10
	Communication.....	11
	Collaboration Areas.....	12
	Committee Members.....	14
	Resources.....	15



RATIONALE

CB SOUTH GOALS

- ✓ Teach and model skills needed for lifelong learning
- ✓ Enhance collaboration by maintaining a supportive atmosphere through trust and mutual accountability and by providing the necessary structure and tools
- ✓ Contribute to and support the "quality of life" at Central Bucks High School South, fostering social and emotional well-being as a foundation for academic achievement and lifelong learning

SUMMARY STATEMENT

If we are looking to accomplish the latter goals, we need to redesign our current schedule to create opportunities for students to refine these skills.

SUPPORTED RESEARCH



World Economic Forum, 2019

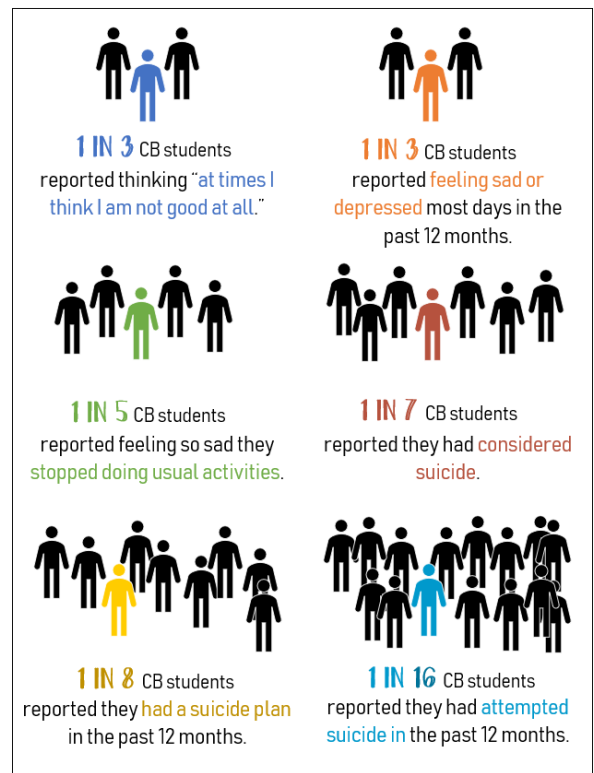

PA Youth Survey Data, 2017

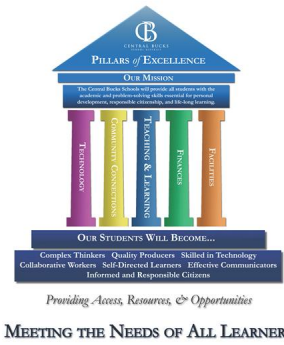

CENTRAL BUCKS' TEACHING AND LEARNING VISION

Central Bucks' Teaching and Learning Vision encapsulates the many benefits of the Lunch and Learn Program as it allows students autonomy over their time, learning, and well-being. During Lunch and Learn, students will build and maintain positive relationships with peers and staff as well as foster their own academic and social-emotional needs and interests. Additionally, faculty will collaborate during this time to plan and create engaging lessons and enrichment activities to ensure student success in and out of the classrooms of CB South.

Rigor & Relevance

1 The secondary instructional program will be evaluated and differentiated to maximize real-world applications, connections, and career/college readiness using best practices.

Growth & Achievement

2 The District will continue to promote, support and evaluate the teaching of higher order thinking skills, medial literacy and digital citizenship, and grading practices that promote student growth and achievement.

Social & Emotional Wellness

3 The District will enhance the school community by providing curriculum, professional development, and additional resources to promote the social and emotional wellness of our students and staff.

Innovation & Leadership

4 The District will continue to support students' progress toward becoming leaders, independent problem-solves, and innovators, both locally and globally, through the provision of extensive, diverse opportunities.



PURPOSE

The purpose of the Lunch and Learn program is to create a schedule that reflects a culture of self-efficacy, trust, and joy. The Lunch and Learn program aligns with our highest priority as educators – meeting the needs of every student, every day.

BENEFITS



Academic

The traditional schedule offers limited flexibility for engaging struggling students. Before and after school arrangements are dependent on the limited availability of students and teachers. Additionally, the traditional schedule leaves little time for students to participate in exploratory and enrichment opportunities.

The Lunch and Learn schedule allows students to meet their academic needs within the school day. Academic opportunities within the Lunch and Learn schedule may include concussion recovery, test make up, AP exam review, art demonstrations, mindfulness practice, and music enrichment.



Social-Emotional

Providing opportunities for student sociability is essential in developing students' intellectual and interpersonal skills. The Lunch and Learn schedule allows students to strengthen these skills which will, in turn, strengthen their relationships inside and outside of the classroom.

Physical activity plays a significant role in social-emotional wellness as it sharpens cognitive skills and decreases stress. During Lunch and Learn, the gymnasium and weight room will be accessible to students for students to run laps, play basketball, and participate in other activities that will allow them to maintain a healthy lifestyle.



Future Preparedness

Whether students are college-bound or entering the workforce after graduation, students need authentic opportunities to practice time management. During Lunch and Learn, students will be empowered to identify their daily needs and act on them. Each day, students will manage their time based on their self-identified needs. This means they could meet with a guidance counselor one day, socialize with friends on another, and participate in an enrichment activity on yet another day.



VISION & MISSION

Central Bucks South High School created a Vision and Mission for the Lunch and Learn Program that aligns with the District Vision and our five Pillars of Excellence.



VISION STATEMENT

Through the Lunch and Learn program, we hope to implement a student-centered schedule that supports student success.

MISSION STATEMENT

To accomplish this, we will create an environment that empowers members of the C.B. South community to:

- Practice self-advocacy and decision-making, prioritizing individual needs.
- Develop life-long responsible habits of mind.
- Maintain social, emotional, physical, and academic balance.
- Meet their academic needs and engage in academic growth.
- Sustain learning connections and relationships, fully benefiting from the power of collaboration.



BELL SCHEDULES

Regular Day: 83-minute blocks, 10-minute Titan Forum

Block 1	7:25 – 8:48	83 minutes
Block 2	8:53 – 10:16	83 minutes
TF	10:20 – 10:30	10 minutes
LL	10:33 – 11:36	63 minutes
Lunch 1	10:33 – 11:03	30 minutes
Lunch 2	11:06 – 11:36	30 minutes
Block 3	11:39 – 1:02	83 minutes
Block 4	1:07 – 2:30	83 minutes

Extended Titan Forum A: 70-71-minute blocks, 60-minute Forum

Block 1	7:25 – 8:36	71 minutes
Block 2	8:41 – 9:52	71 minutes
TF	9:56 – 10:56	60 minutes
LL	10:59 – 12:02	63 minutes
Lunch 1	10:59 – 11:29	30 minutes
Lunch 2	11:32 – 12:02	30 minutes
Block 3	12:05 – 1:15	70 minutes
Block 4	1:20 – 2:30	70 minutes

Extended Titan Forum B: 78-minute blocks, 30-minute Forum

Block 1	7:25 – 8:43	78 minutes
Block 2	8:48 – 10:06	78 minutes
TF	10:10 – 10:40	30 minutes
LL	10:43 – 11:46	63 minutes
Lunch 1	10:43 – 11:13	30 minutes
Lunch 2	11:16 – 11:46	30 minutes
Block 3	11:49 – 1:07	78 minutes
Block 4	1:12 – 2:30	78 minutes

Two-Hour Delay 56-minute blocks, no Forum

Block 1	9:25 – 10:21	56 Minutes
Block 2	10:26 – 11:22	56 Minutes
TF	n/a	n/a
LL	11:25 – 12:30	65 Minutes
Lunch 1	11:25 – 11:55	
Lunch 2	12:00 – 12:30	
Block 3	12:33 – 1:29	56 Minutes
Block 4	1:34 – 2:30	56 Minutes

AM MBIT and PM MBIT Students will have approximately 45-55 minutes of Titan Forum and/or Lunch and Learn.



TEACHER COLLABORATION

Each department has been assigned a day of the week to collaborate. Teachers in course-alike departments and co-teachers will spend this time analyzing student data, creating common assessments, and working on other curricular initiatives.

SCHEDULE FOR DEPARTMENT COLLABORATION

Monday

Health & Physical Education

Tuesday

Mathematics
Social Studies
Art/Industrial Technology

Wednesday

English
Science
Family & Consumer Sciences

Thursday

World Languages
Business
Music

Friday

No Department Meetings



Special Education teachers will be given the option to vary their collaboration days and lunch schedule based on need.



Teachers will not participate in Lunch and Learn on their assigned collaboration day.

TEACHER LUNCH SCHEDULE

Teachers will be available for student support during the 'learn' portion of Lunch and Learn.

'A' LUNCH/'B' LEARN

Family & Consumer Sciences
Music Education
Science
Social Studies
World Languages

'A' LEARN/'B' LUNCH

Art
Business
English
Health/Phys. Ed.
Industrial Technology
Mathematics



SUPERVISION

The Lunch and Learn Supervision Team is comprised of Administrators, Duty Assistants, Security, and Substitutes, totaling at least fifteen adults on any given day. Per Diem and Building Substitutes will be included on this chart on a daily basis. Support Staff lunches will not be scheduled during this time. Responsibilities of the Supervision Team include monitoring and circulating the hallways, bathrooms, common areas, and stairwells. Misconduct and other inappropriate behavior will be reported to Administration and Security immediately.

SUPPORT STAFF SUPERVISION SCHEDULE

Times	Renea Formica	Carolyn Magnus	Becky Santangelo	Lisa Fortunato	Ian Stratton	Rosanna Weitzel	Rich Rohmiller	Joanne Tomczak	Alex Bauer	Grayson Snyder
L&L A	Auditorium lobby	First floor pods	Library	Forum	Third floor pods	Cafeteria	Cafeteria	Second floor pods	Gym	Lunch
L&L B	Cafeteria	Third floor pods	Library	Auditorium lobby	First floor pods	First floor pods	Second floor pods	Cafeteria	Lunch	Gym

*Substitute teachers will be assigned daily supervision. *Building administrators will circulate the building.

 Supervised areas

 Students will be able to access these areas but cannot sit in the hallways in these areas.

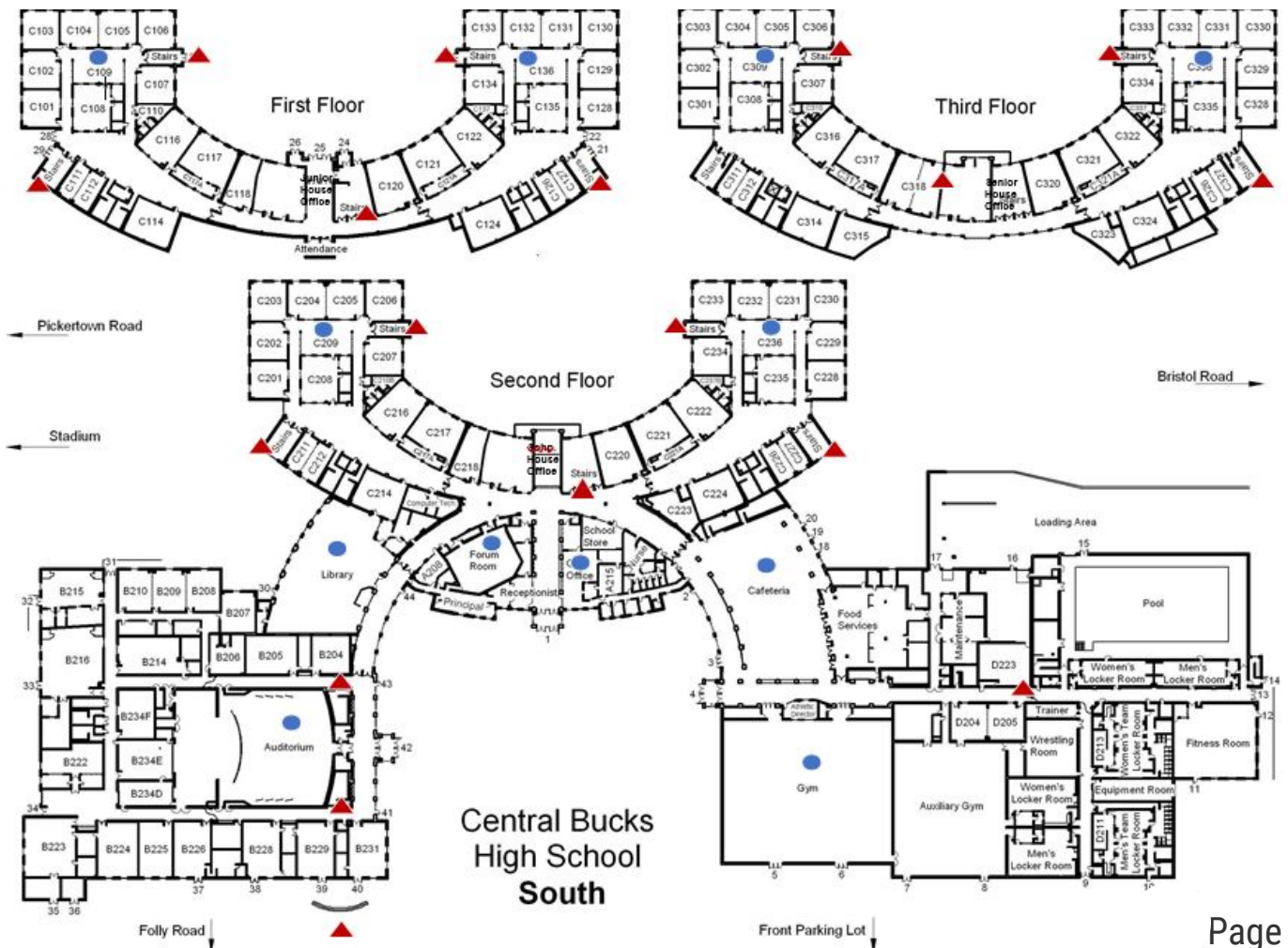



STUDENT EXPECTATIONS

At all times, students are to conduct themselves in an appropriate manner and observe the rules of courtesy to everyone. In addition, students are expected to clean the area where they eat, return lunch trays to the assigned areas, and stay in the areas designated for Lunch and Learn. Tray return bins and trash receptacles will be distributed throughout the campus. Student misconduct will result in a referral to Administration and potentially a temporary loss of Lunch and Learn privileges.

WHAT CAN STUDENTS DO DURING LUNCH AND LEARN?

- ✓ Eat lunch
- ✓ Access teachers
- ✓ Access counselors
- ✓ Make up missed work
- ✓ Exercise (fitness center, gymnasium)
- ✓ Socialize with friends
- ✓ Participate in study groups
- ✓ Participate in enrichment opportunities *

* ENRICHMENT OPPORTUNITIES



Enrichment opportunities may include woodworking, yoga, Spanish movies, cooking demonstrations, guest speakers and more. Clubs will NOT run during Lunch and Learn.



The enrichment programs will be teacher-facilitated. Prior to the activity, teachers will complete a request form that will be approved by an administrator.



COMMUNICATION

Teachers needing to meet with students during Lunch and Learn will send an Outlook calendar invitation through CBSD email. Students will be expected to check their school email on a daily basis.



Students who are being picked up during the school day will be contacted through walkie-talkies, the PA system, or a parent phone call/text.



Students will be notified of enrichment opportunities through a weekly newsletter, Titan TV, and the Titan scroll.

In addition to digital communications, teachers will hang signs on their doors indicating their availability during Lunch and Learn.





COLLABORTATION AREAS

Students will have access to a variety of spaces throughout the building, which will be clearly identified. Stairwells and classrooms will not be available for collaboration. If necessary, students will have access to B and D-wing classrooms for predetermined academic purposes, such as test make-ups or teacher conferencing. Students are NOT permitted to leave campus during Lunch and Learn.

DESIGNATED COLLABORATION SPACES

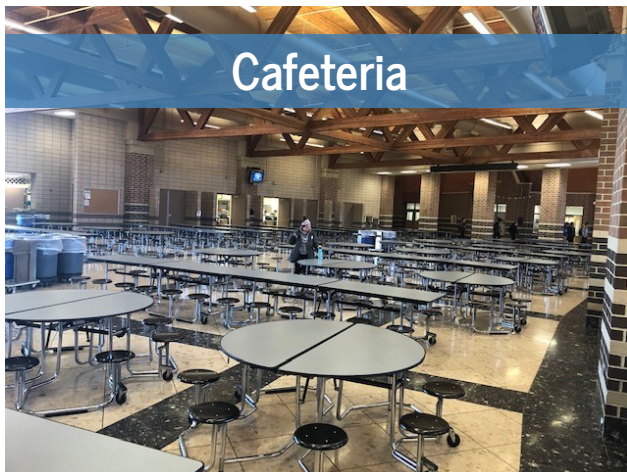

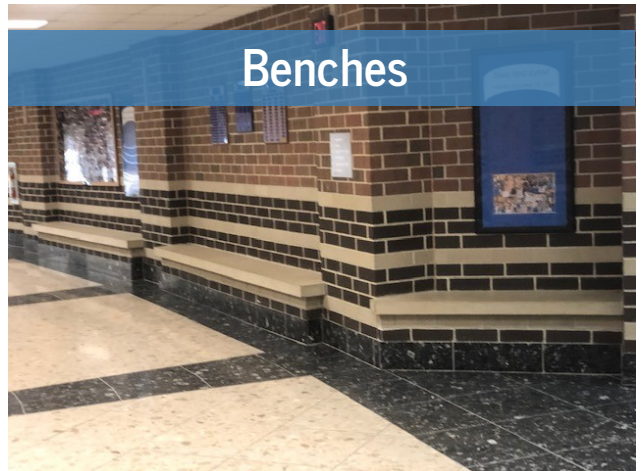

Collaboration and non-collaboration areas will be clearly marked throughout the building.



COMMITTEE MEMBERS

STAFF LUNCH AND LEARN

Jason Bucher, Jenn Opdyke, Joe Piselli, Matt Gale, Jen Atkiss, Pat Balkit, Taryn Barrett, Nancy Bentz, Tara Brouda, Ken Bui, Jeff Clifford, Brian Cox, Mike Cox, John Crea, Cheryl Daly, Amanda Felton, Steve Galazin, Bridget Pustay, Stacy Gray, Beth Howard, Katie Lash, Sarah LeClair, Michael London, Chris McGlone, Will Melvin, Rachel Nulty, Matt Pecic, Onnie Reisinger, Brad Tray, Vello Vilbas, Tina Warren, Ali Wilson, Joel Wussler

Andrew Bates, Anshul Shukla, Tommy Balkir, Aritro Basu, Chloe Dougherty, Emma Cicchiello, Gavin Campbell, Joe Hazell, Miranda Song, Riley Schaefer, Ryan Price, Sana Mahmud

STUDENT LUNCH AND LEARN

STUDENT POD COMMITTEE

Reema Kalidindi, Ore Popoola, Mary Dalessio, Alison Freund, Elizabeth Chiliberti, Jonah Snyder



RESOURCES

To learn more about the Lunch and Learn program, Central Bucks teachers and administrators visited Kiski Area High School, Lower Merion High School, and Unionsville-Chaddsford High School. This is the first year of Lunch and Learn at UCF High School.

WHAT ARE UCF STUDENTS SAYING ABOUT LUNCH AND LEARN?

"I enjoy the hour to decompress and get a start on my homework. Sometimes just socializing with my friends can change the mood of my day!"

"Lunch and Learn gives me a lot of time to ask my teachers for help, complete homework, and have a decent amount of time to eat lunch.

WHAT IMPACT HAS LUNCH AND LEARN HAD ON THE FOLLOWING AREAS? Student Responses

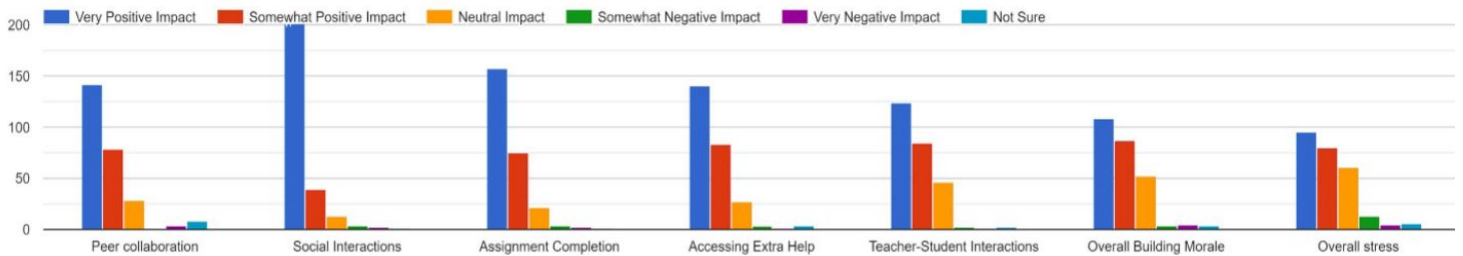

"We are creating a culture where getting support and checking in with your teacher is the norm. Students proactively check in when they are going to miss class for an early dismissal."

"Students have a chance to breathe throughout the day. Students seem less stressed and more behaved in class. As a teacher, I have a chance to meet with colleagues and students."

WHAT IS UCF STAFF SAYING ABOUT LUNCH AND LEARN?

WHAT IMPACT HAS LUNCH AND LEARN HAD ON THE FOLLOWING AREAS? Staff Responses

